



SAFETY AND OPERATING MANUAL
3 IN 1 Pressure Washer Wet & Dry
PWV1500



ORIGINAL INSTRUCTIONS



PWV1500

Welcome to Gardenjack!

Dear Customer, Congratulations on your purchase. Before using the Product for the first time please be sure to read these instructions for use. They provide you with all information necessary for using the product safely and to ensure its long service life.

Closely observe all safety information in these instructions!

General Safety Warnings.....	01 - 02
Safety Symbols	03
Machine Details and Product Includes.....	04
Assembly.....	05 - 06
Pressure Washer Operation.....	07
Vacuum Operation & Care / Maintenance.....	08
Troubleshoot.....	09
Gardenjack Guarantee.....	10
Gardenjack Guarantee & EC Declaration.....	11
Declaration.....	12
Parts List.....	13
Parts Diagram.....	14

GENERAL SAFETY WARNINGS

WARNING Read all safety warnings and all instructions. Failure to follow the warnings and instructions may result in electric shock, fire and/or serious injury.

Save all warnings and instructions for future reference. The term "power tool" in the warnings refers to your electric (corded) power tool or battery-operated (cordless) power tool.

1. Work area safety

a) Keep work area clean and well lit. Cluttered or dark areas invite accidents.

b) Do not operate power tools in explosive atmospheres, such as in the presence of flammable liquids, gases or dust. Power tools create sparks which may ignite the dust or fumes.

c) Keep children and bystanders away while operating a power tool. Distractions can cause you to lose control.

2. Electrical safety

a) Power tool plugs must match the outlet. Never modify the plug in any way. Do not use any adapter plugs with grounded power tools. Unmodified plugs and matching outlets will reduce risk of electric shock.

b) Avoid body contact with grounded surfaces, such as pipes, radiators, ranges and refrigerators. There is an increased risk of electric shock if your body is grounded.

c) Do not expose power tools to rain or wet conditions. Water entering a power tool will increase the risk of electric shock.

d) Do not abuse the cord. Never use the cord for carrying, pulling or unplugging the power tool. Keep cord away from heat, oil, sharp edges or moving parts. Damaged or entangled cords increase the risk of electric shock.

e) When operating a power tool outdoors, use an extension cord suitable for outdoor use. Use of a cord suitable for outdoor use reduces the risk of electric shock.

f) If operating a power tool in a damp location is unavoidable, use a residual current device (RCD) protected supply. Use of an RCD reduces the risk of electric shock.

3. Personal safety

a) Stay alert, watch what you are doing and use common sense when operating a power tool. Do not use a power tool while you are tired or under the influence of drugs, alcohol or medication. A moment of inattention while operating power tools may result in serious personal injury.

b) Use personal protective equipment. Always wear eye protection. Protective equipment such as dust mask, non-skid safety shoes, hard hat, or hearing protection used for appropriate conditions will reduce personal injuries.

c) Prevent unintentional starting. Ensure the switch is in the off position before connecting to power source and/or battery pack, picking up or carrying the tool. Carrying power tools with your finger on the switch or energising power tools that have the switch on invites accidents.

d) Remove any adjusting key or wrench before turning the power tool on. A wrench or a key left attached to a rotating part of the power tool may result in personal injury.

GENERAL SAFETY WARNINGS

e) Do not over reach. Keep proper footing and balance at all times. This enables better control of the power tool in unexpected situations.

f) Dress properly. Do not wear loose clothing or jewellery. Keep your hair, clothing and gloves away from moving parts. Loose clothes, jewellery or long hair can be caught in moving parts.

g) If devices are provided for the connection of dust extraction and collection facilities, ensure these are connected and properly used. Use of dust collection can reduce dust-related hazards.

4. Power tool use and care

a) Do not force the power tool. Use the correct power tool for your application. The correct power tool will do the job better and safer at the rate for which it was designed.

b) Do not use the power tool if the switch does not turn it on and off. Any power tool that cannot be controlled with the switch is dangerous and must be repaired.

c) Disconnect the plug from the power source and/or the battery pack from the power tool before making any adjustments, changing accessories, or storing power tools. Such preventive safety measures reduce the risk of starting the power tool accidentally.

d) Store idle power tools out of the reach of children and do not allow persons unfamiliar with the power tool or these instructions to operate the power tool. Power tools are dangerous in the hands of untrained users.

e) Maintain power tools. Check for misalignment or binding of moving parts, breakage of parts and any other condition that may affect the power tool's operation. If damaged, have the power tool repaired before use. Many accidents are caused by poorly maintained power tools.

f) Keep cutting tools sharp and clean. Properly maintained cutting tools with sharp cutting edges are less likely to bind and are easier to control.



g) Use the power tool, accessories and tool bits etc. in accordance with these instructions, taking into account the working conditions and the work to be performed. Use of the power tool for operations different from those intended could result in a hazardous situation.

5. Service

a) Have your power tool serviced by a qualified repair person using only identical replacement parts. This will ensure that the safety of the power tool is maintained.

b) If the replacement of the supply cord is necessary, this has to be done by the manufacturer or its agent in order to avoid a safety hazard.

SAFETY SYMBOLS

SYMBOL	DESCRIPTION
	Read the manual before set-up and/or use.
	Do not dispose with house-hold waste.
	Conforms to relevant safety standards.

MACHINE DETAILS AND PRODUCT INCLUDES

Technical Specifications:

Model. No	Vacuum Cleaner
Rated voltage:	AC220-240 V, 50/60Hz
Rated input power:	1200W
Max Vacuum Degree	≥15KPa
Max Airflow	≥2.8m ³ /min
Max Suction Power	≥340W
Model. No	Pressure Washer
Rated voltage:	AC220-240V, 50/60Hz
Rated input power:	1500W
Protection class	II
Degree of protection:	IPX5
Rated pressure:	8MPa
Max. pressure:	12MPa
Rated flow:	5.5 l/min
Max. flow:	6/min
Rated temperature:	0-40°C
Max. inlet pressure:	0.7MPa
Sound pressure level:	L _{pA} =77 dB(A)
Uncertainty:	K _{PA} =3dB
Sound power level:	L _{wA} =92dB (A)
Vibration value	α _h =3.81m/s ² K _{αh} =1.5m/s ²
Weight:	13Kg



Sound power level is 92dB(A)

Included:

1. Handle
2. Power cord hook
3. Trigger gun holder
4. Dust compartment
5. Water outlet
6. Wheels
7. Blow air outlet
8. Trigger gun
9. Floor brush
10. High-pressure hose hook
11. High-pressure hose
12. Power cable
13. Nozzle
14. Detergent bottle
15. Rear case
16. Power cord
17. Extension Tubes

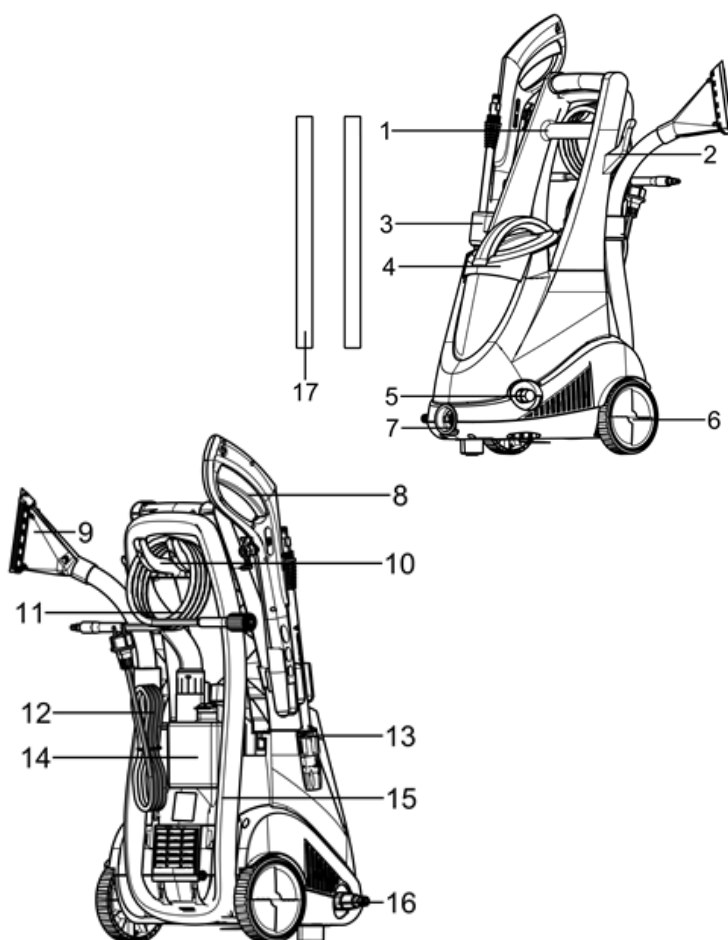

Assembly Instructions

1. Installing the handle

Place the handle frame of the pressure washer into position, then slide down for the handle to then slot into place. Use the screws provided to then secure.

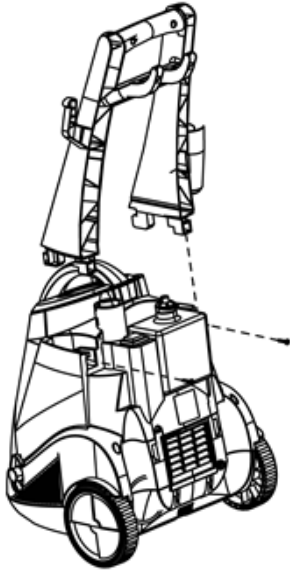

2. Slide the trigger gun hook into position

On the side of the handle frame, slide the trigger hook in a downwards position to be slotted into place.

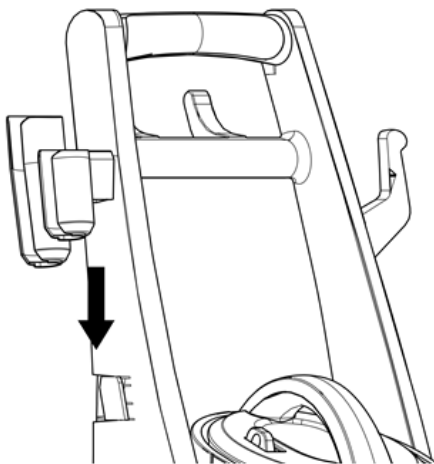

3. Installing the dust compartment into position

Secure the dust compartment by sliding this into position at the front of the pressure washer.

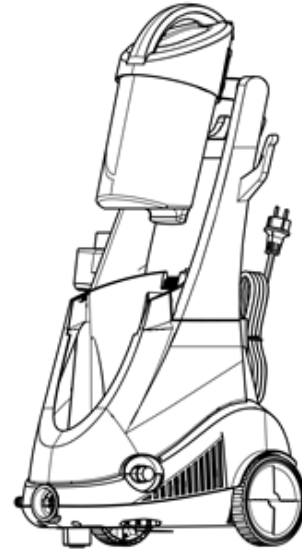

4. Installing the spray wand to the trigger gun

Fit the spray wand into the gun handle and rotate anti clockwise until the two parts are completely locked.

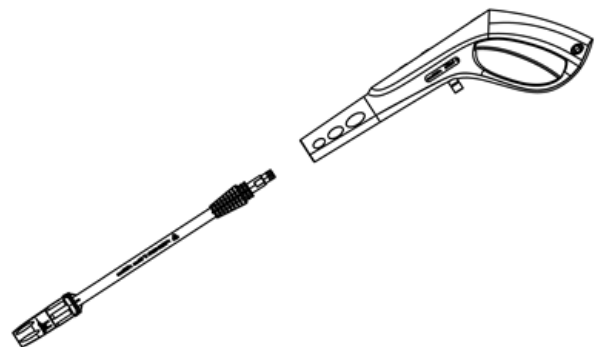

Assembly Instructions

5. Connect the high pressure hose to the trigger gun

Connect the silver end of the pressure hose to the trigger gun and tighten the nut to secure the connection.

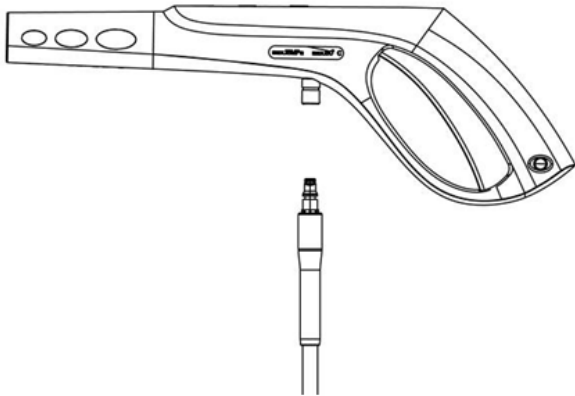

6. Connect the high-pressure hose to the water outlet

Connect the other end of the pressure hose to the water outlet on the side of the pressure washer and tighten the black rotatable end-piece to secure the connection.

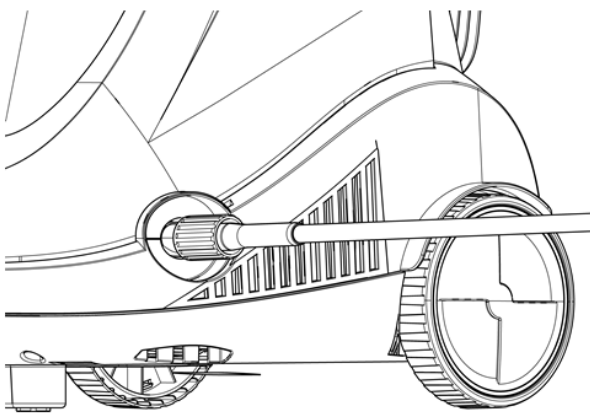

7. Connect the garden hose to the water inlet

Connect the garden hose adaptor (female coupling) to the water inlet of the pressure washer, then thread your garden hose (male end) into the hose adaptor.

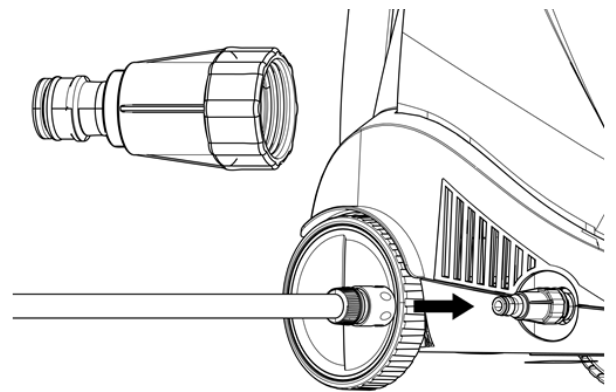

PRESSURE WASHER OPERATION

CAUTION

Keep a distance of at least 30cm when using the jet for cleaning painted surfaces to avoid damage.

CAUTION

Make sure the on/off switch is set to "OFF/O" while inserting the plug into the main socket.

The Pressure Washer must be used on a secure and stable surface in a standing, upright position.

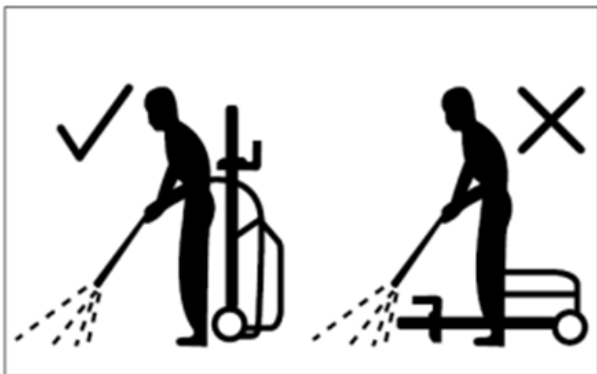

Connect the pressure washer to the power and water supply as described.

- Open the water supply
- Hold the spray gun with both hands.
- Direct the nozzle of the chosen accessory away from you towards the surface to be cleaned.
- Unlock the trigger and press it until a constant amount of water flows through the nozzle, to allow air trapped in the hose to escape.
- Release the trigger.
- Turn on the switch "PW(I)"

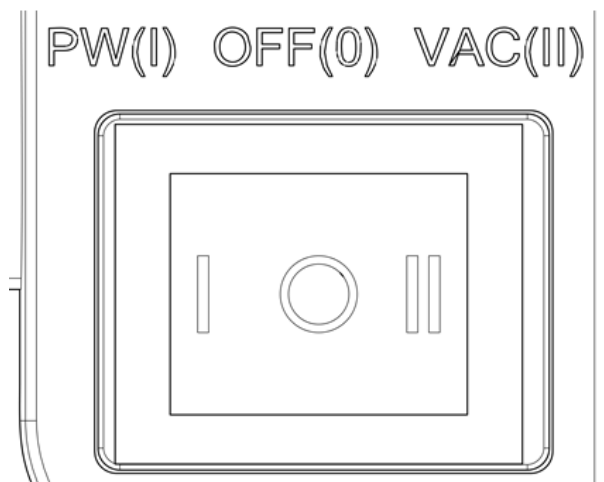

- While holding the trigger direct the water jet to the object to be cleaned.
- Release the lever of the trigger, the jet will the switch off again and stop pushing water through the system.

WARNING! Beware of kickback when pressing the trigger.

OPERATING WITH DERTERGENT

Detergent can only be added when the device is operated in low pressure mode.

Remove the cap of the detergent bottle. Gently pull the on-board detergent tank out of its storage position.

Fill the tank with detergent designed specifically for use with the pressure washer.

Push the detergent bottle with the opening pointing downwards into the connection.

VACUUM CLEANER OPERATION /CARE AND MAINTENANCE

CAUTION

Make sure the on/off switch is set to "OFF/O" while inserting the plug into the main socket.

Open the air flow on the hose handle by sliding downwards. This will decrease the suction. Close the air flow by sliding upwards. This will then increase the suction.

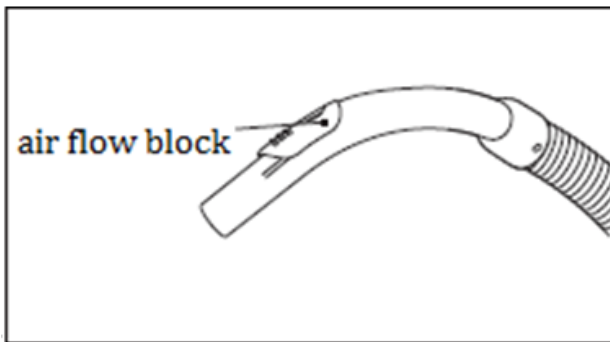

Turn on the switch VAC(II) so ready to use.

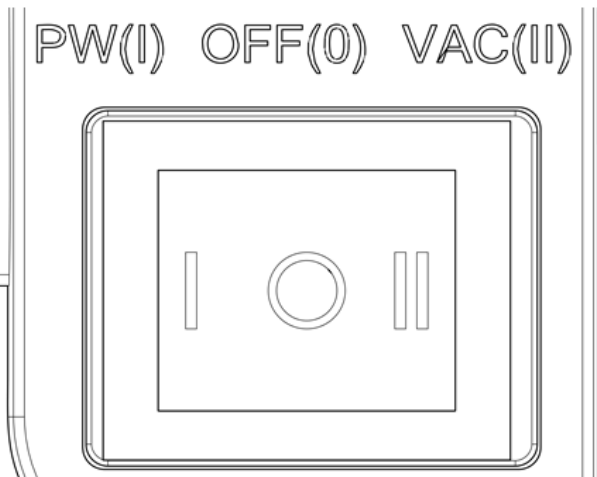

CARE AND MAINTENANCE

- Store the hose carefully to avoid kinks.
- Keep away from sharp edges or corners.
- Clean the filter in the water connection regularly.

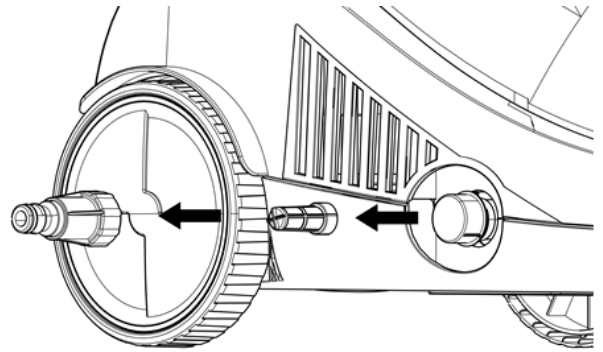

- Clean the nozzle with the needle clean-out tool provided.

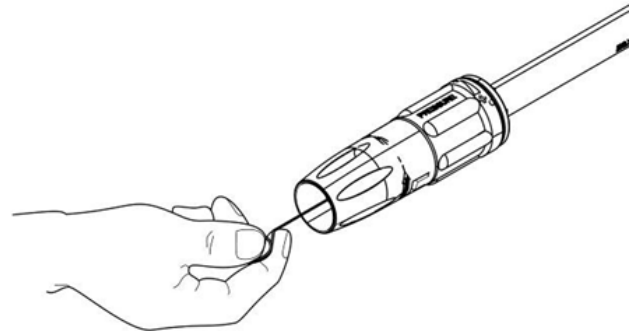

- Press the automatic release button to empty the dust into the container for disposal.

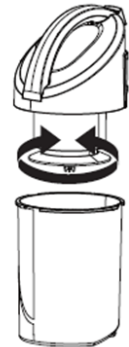

TROUBLESHOOTING

Turn off the appliance and remove the main plug prior to performing any care and maintenance work. Repair work and work on the electrical components may not only be performed by an authorized customer service. You can rectify minor faults yourself with the help of the following overview. If in doubt, please consult the authorised customer service.

Symptom	Cause	Recommended action
Machine refuses to start	Machine not plugged in Defective socket Fuse has blown Defective extension cord	Plug in machine Try another socket. Replace fuse. Switch off other machines. Try without the extension cord.
Fluctuating pressure	Pump sucking air Valves dirty, worn out or stuck Pump seals worn out	Check that hoses and connections are airtight. Clean and replace or refer to local distributor Clean and replace or refer to local distributor
Machine stops	Incorrect mains voltage Thermal sensor activated Nozzle partially blocked	Check that the mains voltage corresponds to specification on the model tag. Leave the washer for 5 minutes to cool down. Clean the nozzle
Machine pulsating	Air in inlet hose Inadequate supply of mains water Nozzle partially blocked Water filter blocked Hose kinked	Allow machine to run with open trigger until regular working pressure resumes. Check that the water supply corresponds to specifications required NB! Avoid using long, thin hoses (min. 1/2"). Clean the nozzle /Clean the filter. Straighten out hose.
Machine starts, but no water comes out	Pump/hoses or accessory frozen No water supply Water filter blocked /Nozzle blocked	Wait for pump/hoses or accessory to thaw. Connect inlet water. Clean the filter /Clean the nozzle

GARDENJACK GUARANTEE

1. Guarantee

1.1 Lumberjack guarantees that for a period of 12 months from the date of purchase the components of qualifying products (see clauses 1.2.1 to 1.2.8) will be free from defects caused by faulty construction or manufacture. **1.2.** During this period Lumberjack, will repair or replace free of charge any parts which are proved to be faulty in accordance with paragraph 1.1 providing that: **1.2.1** You follow the claims procedure set out in clause 2 **1.2.2** Lumberjack and its authorised dealers are given reasonable opportunity after receiving notice of the claim to examine the product **1.2.3** If asked to do so by Lumberjack or its Authorised dealer, you return the product at your own cost to Lumberjack's or supplying Authorised Dealer's premises, for the examination to take place clearly stating the Returns Material Authorisation number given by Lumberjack or an Authorised Dealer. **1.2.4** The fault in question is not caused by industrial use, accidental damage, fair wear and tear, wilful damage, neglect, incorrect electrical connection, misuse, or alteration or repair of the product without approval. **1.2.5** The product has been used in a domestic environment only **1.2.6** The fault does not relate to consumable items such as blades, bearings, drive belts, or other wearing parts which can reasonably be expected to wear at different rates depending on usage.

1.2.7 The product has not been used for hire purposes. **1.2.8** The product has been purchased by you as the guarantee is not transferable from a private sale. **2. Claims Procedure**
2.1 In the first instance please contact the Authorised Dealer who supplied the product to you. In our experience many initial problems with machines that are thought to be faulty due to faulty parts are actually solved by correct setting up or adjustment of the machine. A good Authorised Dealer should be able to resolve the majority of these issues much more quickly than processing a claim under the guarantee. If a return is requested by the Authorised Dealer or Lumberjack, you will be provided with a Returns Material Authorisation number which must be clearly stated on the returned package, and any accompanying correspondence. Failure to provide a Returns Material Authorisation number may result in item being refused delivery at Authorised Dealer. **2.2** Any issues with the product resulting in a potential claim under the guarantee must be reported to the Authorised Dealer from which it was purchased within 48 hours of Receipt. **2.3** If the Authorised Dealer who supplied the product to you has been unable to satisfy your query, any claims made under this Guarantee should be made directly to Lumberjack.

GARDENJACK GUARANTEE / EC DECLARATION OF CONFORMITY

of purchase to Lumberjack. If you include a contact number with this it will speed your claim up.

2.4 Please note that it is essential that the letter of claim reaches Lumberjack on the last day of this Guarantee at the latest. Late claims will not be considered.

3. Limitation of Liability

3.1 We only supply products for domestic and private use. You agree not to use the product for any commercial, business or resale purposes and we have no liability to you for any loss of profit, loss of business, business interruption or loss of business opportunity.

3.2 This Guarantee does not confer any rights other than these expressly set out above and does not cover any claims for consequential loss or damage. This Guarantee is offered as an extra benefit and does not affect your statutory rights as a consumer.

4. Notice

This Guarantee applies to all product purchased from an Authorised Dealer of Lumberjack within the United Kingdom. Terms of Guarantee may vary in other countries.

EC DECLARATION OF CONFORMITY

We hereby declare that the machine described below complies with the relevant basic safety Directives, both in its basic design and construction as well as in the version put into circulation by us. This declaration shall cease to be valid if the machine is modified without our prior approval.

Product: High pressure cleaner

Type: YE01-120-1

Relevant EU Directives

2000/14/EC

2014/30/EU

2006/42/EC

2011/65/EU

Applied harmonised standards

EN 55014—1

EN 55014—2

EN 60335—1

EN 60335—2—79

EN60335-2-2

EN 61000—3—2: 2014

EN 61000—3—3: 2013

EN 62233: 2008

Applied conformity evaluation method

2000/14/EC: Appendix V

Sound power level dB(A)

Measured:77 dB(A)

Guaranteed:92dB(A)

The undersigned act on behalf and under the power of attorney of the company management.

Authorised Documentation

Representative

CE DECLARATION OF CONFORMITY

GARDENJACK

Unit C, Manders Ind. Est.,
Old Heath Road, Wolverhampton,
WV1 2RP.

Tel: 01902 450 470

Declares that the **3IN1 PRESSURE WASHER WET & DRY VACUUM (PWV1500)**
Is in compliance with the regulations included in the Directives: 2014/35/EU

EC DECLARATION OF CONFORMITY

Certificate for EC-type examination delivered by Intertek Testing Services Hangzhou – 16 No. 1 Ave.,
Xiasha Economic Development District, Hangzhou 310018, China (Registration No.:190900418HZH-
V1)

Person who declares: Bill Evans



07.04.2021

The Director



Parts List

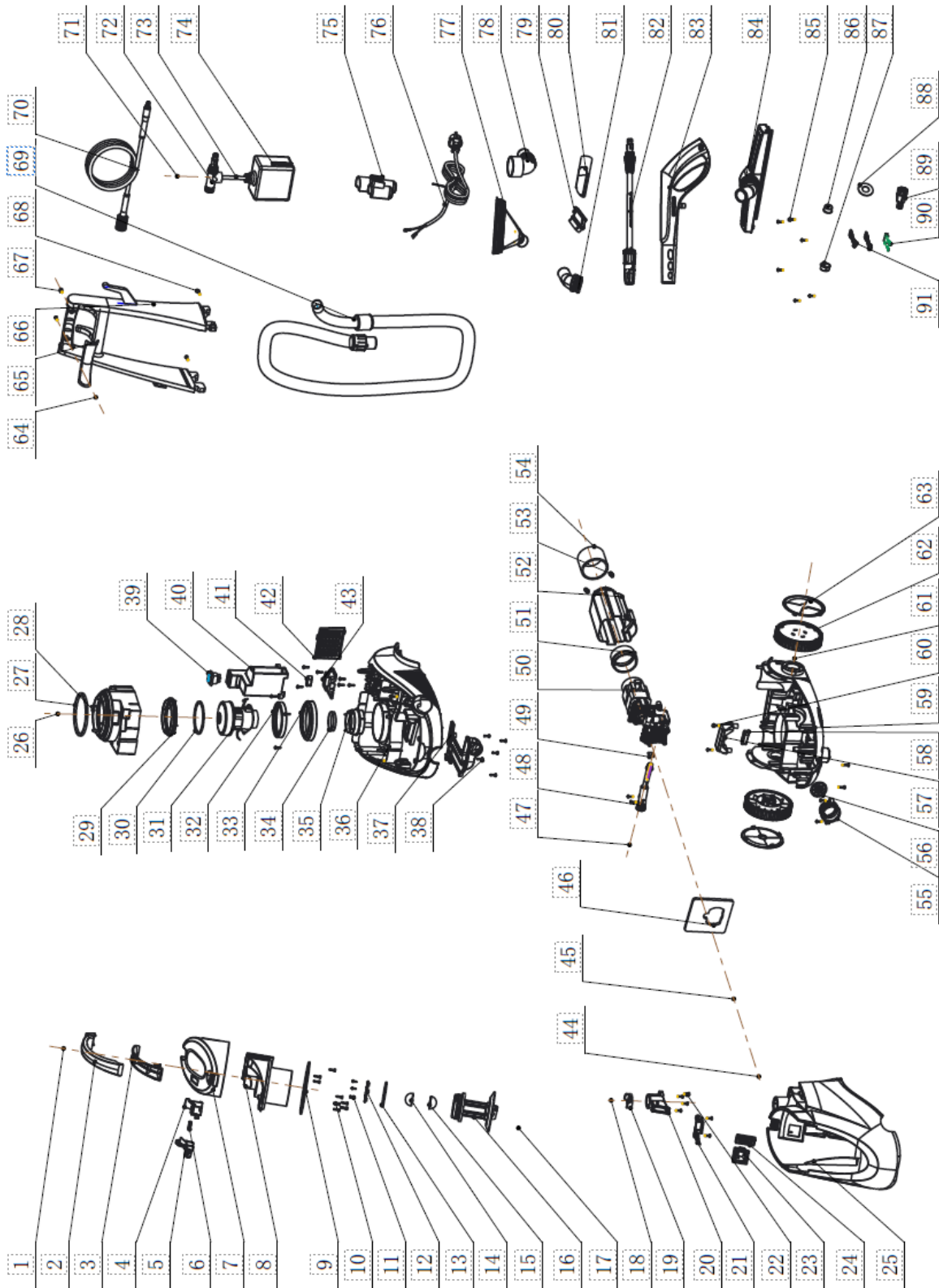

Parts List

No	Name	Qty	No	Name	Qty
1	Dust container assembly	1	46	front strainer	1
2	Dust container handle cover	1	47	Motor/pump with water inlet tube	1
3	Dust container handle	1	48	water inlet tube	1
4	Dust container lock bracket	1	49	U-pin	1
5	Dust container lock button	1	50	Motor/pump without water inlet tube	1
6	Dust container lock spring	1	51	Motor cover block	1
7	Dust container cover	1	52	Fan cover	1
8	Dust container air tube	1	53	Fan waterproof protector	2
9	Dust container air tube seal	1	54	Back motor housing filter	1
10	Spaced thread screw(Small head)	10	55	Air out sucking pole base	1
11	Cross head self-tapping screw	3	56	Dry air block	1
12	Floating ball block	1	57	Pump fixture	1
13	Filter bracket seal	1	58	Pump fix sheath	1
14	Floating ball Left	1	59	Base	1
15	Floating ball right	1	60	Spaced thread screw(Big head)	6
16	HEPA filter assemble	1	61	Wheel assembly	2
17	Dust container	1	62	Wheel	2
18	Top cover assembly	1	63	Wheel cover	2
19	Air Tube seal ring	1	64	Handle assembly	1
20	Air Tube	1	65	Handle cover rubble coating	1
21	Dust container air outlet water blocking	1	66	Handle	1
22	Spaced thread screw(Big head)	6	67	Spaced thread screw(Big head)	2
23	Dust container seal ring	1	68	ST Screw ST3.9X20	6
24	Dust container air inlet seal ring	1	69	Soft tube assembly	1
25	Top cover	1	70	Hose	1
26	Middle Frame Assembly	1	71	Detergent Tank assembly	1
27	Motor cover seal ring	1	72	Tank connector	1
28	Motor housing	1	73	siphon tube	1
29	D28 motor lower gland	1	74	Tank only	1
30	D28 motor seal ring	1	75	Gun holder	1
31	D28 motor for dry/wet using	1	76	Power cord assembly (2 pin Europe plug)	1
32	Motor upper seal ring	1	77	triangle brush	1
33	D28 motor upper gland	1	78	Shop-vac adapter	1
34	Fan cover seal ring	1	79	Hairbrush sucker	1
35	D28 motor extension tube	1	80	Ablate suction nozzle	1
36	Middle Frame	1	81	Round brush	1
37	Air tube cover	1	82	Sprary lance	1
38	Screw ST3.9*16	16	83	Gun	1
39	Three position switch	1	84	wet and dry floor brush	1
40	Switch cover	1	85	Spaced thread screw(Big head)	6
41	Card line block	1	86	Water outlet thread cap	1
42	Air inlet block	1	87	Water intlet thread cap	1
43	Switch cover seal ring	1	88	Pump outlet block	1
44	motor/pump assembly with cover	1	89	water inlet filter	1
45	motor/pump assembly	1	90	capacitor	1
46	front strainer	1	91	inductance	2

