

XP SERIES

LUMBER JACK

Original Manual Battery Charger & Batteries

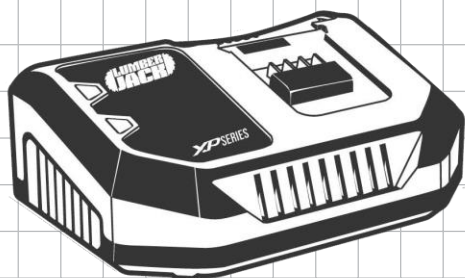
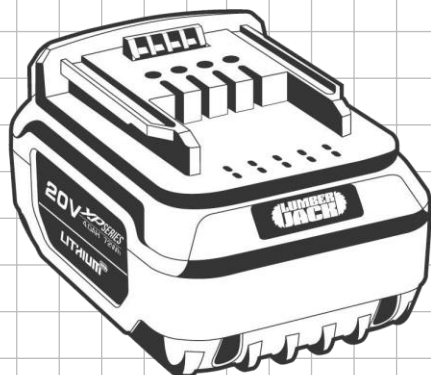
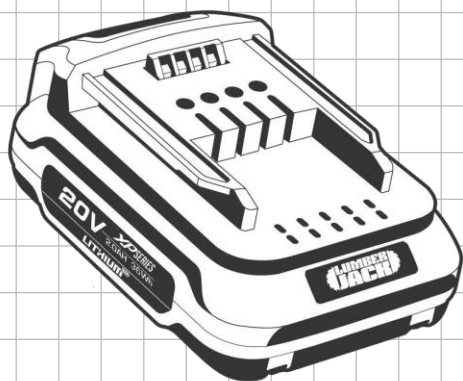

WARNING

Read this manual before using this product.
Failure to do so can result in serious injury.
SAVE THIS MANUAL.



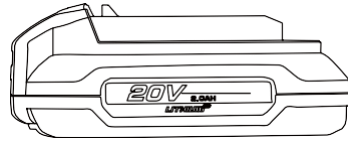

Battery 2A

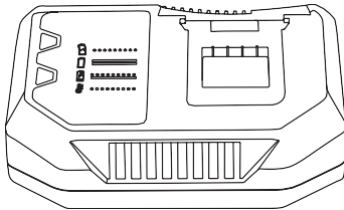

Charger

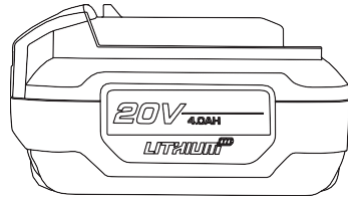

Battery 4A

Index

Product Description and Specification.....	01
Save These Instructions.....	01
Safety Notes.....	01
Product Features.....	02
Technical Data.....	02
Charging Time for Battery Capacity, APPROX.	03
Operation.....	03
Charging.....	03
Indicating the remaining battery capacity (Fig.1&2).....	04
Troubleshooting-Causes and Corrective Measures.....	05
Working Advice.....	05
Maintenance and Service.....	05

Product Description and Specification

⚠ WARNING : Read all safety warnings and all instructions. Failure to follow the warnings and instructions may result in electric shock, fire and/or serious injury.

Save These Instructions

Use the battery charger only when you fully understand and can perform all functions without limitation, or have received appropriate instructions.

Safety Notes

- a. **Keep the battery charger away from rain or moisture.** Penetration of watering the battery charger increases the risk of an electric shock.
- b. **Only charge Lumberjack batteries installed in Lumberjack products. The battery voltage must match the battery charging voltage of the charger.** Otherwise there is danger of fire and explosion.
- c. **Keep the battery charger clean.** Contamination can lead to danger of an electric shock.
- d. **Before each use, check the battery charger, cable and plug. If damage is detected, do not use the battery charger. Never open the battery charger yourself. Have repairs preformed only by a qualified technician and only using original spare parts.** Damaged battery chargers, cables and plugs increase the risk of an electric shock.
- e. **Do not operate the battery charger on easily inflammable surfaces (e.g., paper, textiles, etc.) surroundings.** The heating of the battery charger during the charging process can pose a fire hazard.
- f. **In case of damage and improper use of the battery, vapors may be emitted. Ventilate the area and seek the medical help in case of complaints.** The vapors can irritate the respiratory system.
- g. **Supervise children.** This will ensure that children do not play with the charger.
- h. **This battery charger can be used by children aged from 8 years and above and persons with reduced physical, sensory or mental capabilities or lack of experience and knowledge if they have been given supervision or instruction concerning use of the battery charger in a safe way and understand the hazards involved.**
- i. **Cleaning and use maintenance of the battery charger shall not be made**

by children without supervision.

j. Do not cover off the ventilation slots of the battery charger. Otherwise, the battery charger can overheat and no longer operate properly.

⚠ NOTE : If the plug is not suitable for your socket outlets, it should be cut off and an appropriate plug fitted in its place by an authorized customer service agent. The replacement plug should have the same fuse rating as the original plug.

Product Features

The numbering of the product features refers to the illustration of the battery charger on the graphics pages.

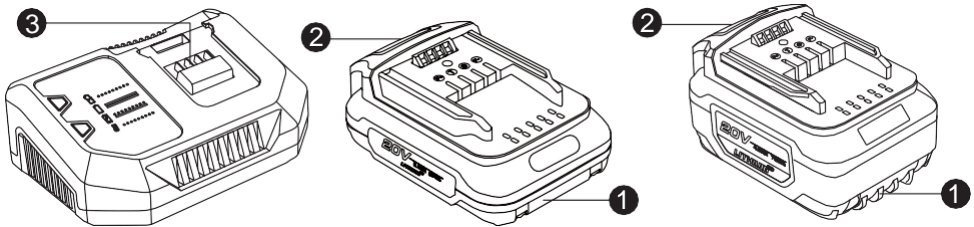

1. Battery pack
2. Battery charge indicator
3. Charging compartment

Technical Data

Charger	
Output Voltage & Frequency	100-240V/50-60HZ
Charger Current	4A
Allowable Charging Temperature Range	0-40°
Weight	0.525KG
Protection Class	□ / II
Please observe the article number on the type plate of your battery charger. The trade names of individual battery chargers may vary.	

Charging Time for Battery Capacity, APPROX.

Type of Battery	2A Battery	4A Battery
Number of battery cells	5	10
Charging time	About 40 min	About 60 min

Operation

⚠ WARNING : Observe the main voltage ! The voltage of the power supply must correspond with the data given on the nameplate of the battery charger.

Charging

a. The charging procedure starts as soon as the mains plug of the battery charger is plugged into the socket outlet and the battery is inserted into the charging compartment.

b. Due to the intelligent charging method, the charging condition of the battery is automatically detected and the battery is charged with the optimum charging current, depending on battery temperature and voltage.

c. This gives longer life to the battery and always leaves it fully charged when kept in the charger for storage.

⚠ NOTE : The rapid-charging procedure is only possible when the battery temperature is within the allowable charging temperature range.

Status	LED(Red)	LED(Green)
Plug power supply. (Without battery)	ON	OFF
Insert battery	ON	Flash
Insert battery (Full battery)	ON	ON
Insert battery (After run out, the battery has a high temperature.)	Flash	OFF
Insert battery (Damaged battery)	Red light and green light flash alternately.	

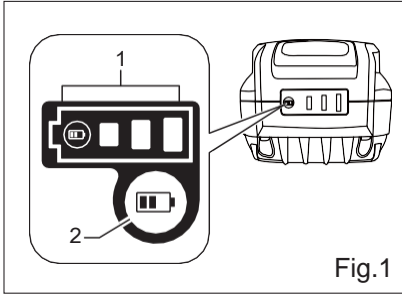

1			6
3	4	5	
█	□	▬	66% - 100%
█	█	█	33% - 66%
█	█	█	0% - 33%

Fig.2

1. Indicator Lamps
2. Check Button
3. Lighted
4. Off
5. Blinking
6. Remaining Capacity

Indicating the remaining battery capacity (Fig.1&2)

Press the check button on the battery cartridge to indicate the remaining battery capacity. The indicator lamps light up for few seconds.

⚠ NOTE :

Depending on the conditions of use and the ambient temperature, the indication may differ slightly from the actual capacity.

⚠ NOTE :

a. The battery charger is for charging Lumberjack battery pack. Never use it for other purposes or for other manufacturer's batteries.

b. When you charge a battery pack which is new or has not been used for a long period of time, it may not accept a full charge until after discharging it completely and recharging a couple of times.

c. Battery condition is as below and charging may not start.

-Battery pack from just-operated tool or battery cartridge that has been left in a location exposed to direct sunlight for a long time.

-Battery pack that has been left for a long time in a location exposed to cold air.

Charging will begin after the battery pack temperature reaches the degree at which charging is possible.

d. If the charging light flashes alternately in green and red color, charging is not possible. The terminals on the charger or battery cartridge are clogged with dust or the battery cartridge is worn out or damaged.

Troubleshooting-Causes and Corrective Measures

Cause	Corrective Measure
Battery not (properly) inserted	Properly insert battery into battery charger
Battery contacts contaminated	Clean the battery contacts (e.g. by inserting and removing the battery several times) or replace the battery
Battery pack defective	Replace the battery
Mains plug of battery charger not plugged in (Properly)	Insert mains plug (fully) into the socket outlet
Socket outlet, mains cable or battery charger defective	Check the mains voltage; have the battery charger checked by an authorized after-sales service agent for Lumberjack power tools.

Working Advice

With continuous or several repetitive charging cycles without interruption, the charger can warm up. This is not meaningful and does not indicate a technical defect of the battery charger.

A significantly reduced working period after charging indicates that the battery is used and must be replaced.

CE DECLARATION OF CONFORMITY

TOOLSAVE

Unit C, Manders Ind. Est.,

Old Heath Road, Wolverhampton,

WV1 2RP.

Tel: 01902 450 470

EC DECLARATION OF CONFORMITY

Certificate for EC-type examination delivered by Interk Testing Services Hangzhou 16

No. 1 Ave., Xiasha Economic Development District, Hangzhou 310018, China

(Verification No.:150500566HZH-V1)

Person who declares: Bill Evans



01.05.2016

The Director



LUMBER **JACK**

LUMBERJACK TOOLS
UNIT C MANDERS INDUSTRIAL
ESTATE WOLVERHAMPTON WV1
2RP

WWW.LUMBERJACKTOOLS.CO.UK